



HANDLING INSTRUCTION

FIBERFOX | Fiber Chassis Connector 2 & 4-channel



CAUTION:
Laser radiation CLASS 1. Do not look directly into beam of light!

A Chassis Connector Cleaning / Inspection

Tools:

- Distilled water
- Dust remover (Air in a can)
- STICKLERS Clean STIXX MCC-EB12 - Expanded Beam Lens



Disconnect both cable ends for safety reasons.

Do not stare into beams or view directly with optical instruments.

A Remove the protection cap.



B Check the lenses for contamination.

C If there is no visible contamination.
→ No cleaning necessary.

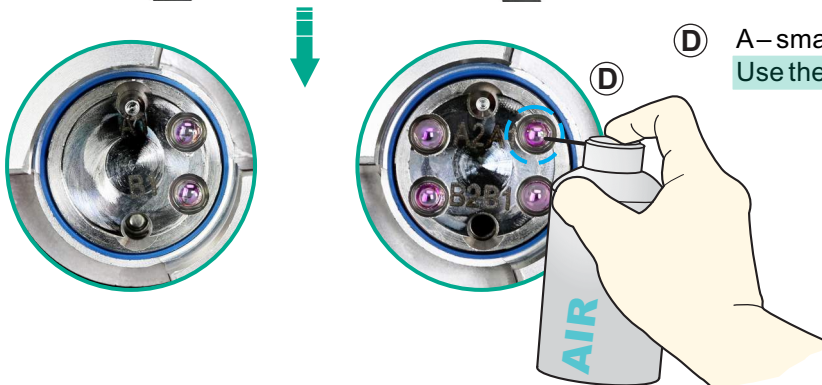

D A – small contamination:
Use the dust remover to apply air to the lenses.

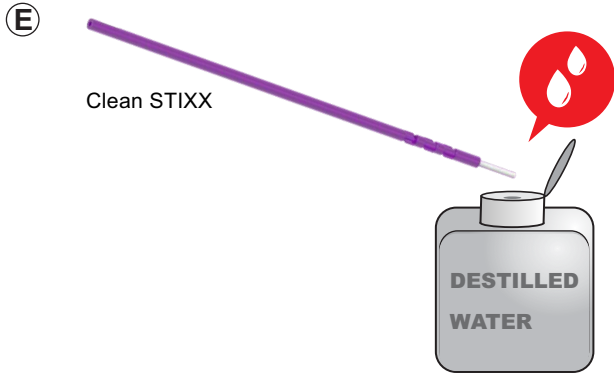

E B – heavy contamination:
Moisten the tip of the STICKLERS Clean STIXX with some drops of distilled water.

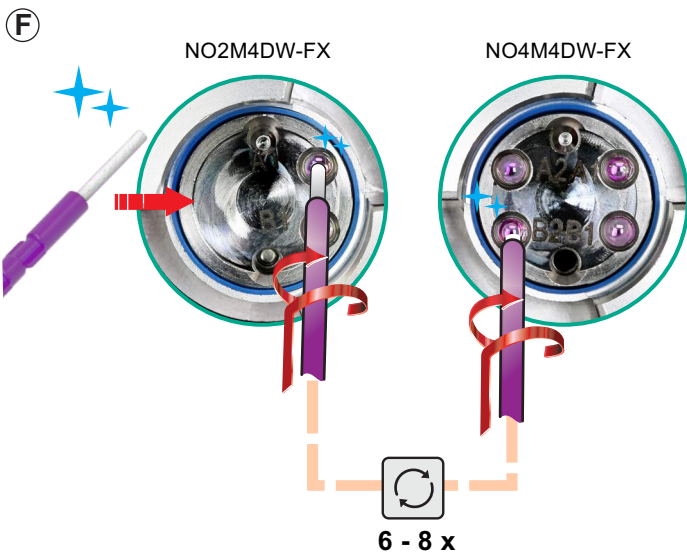

F Apply the moistened tip to the lens.

Remove dust residuals by rotating the tip of the swab.
Rotate the swab six to eight times in one direction.

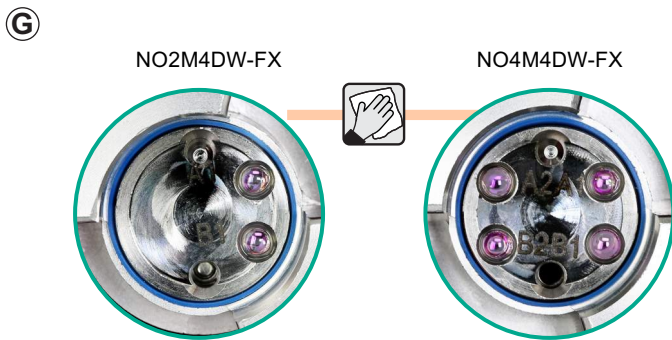

G Dry the entire surface with a lint-free wipe or a similar material.



H After cleaning the lenses apply the protection cap.

