

Part number

# PHW 6365 SV



## Brief description:

hoods, plugs, 3 poles + N + PE, 63 (A.C.), 346 ÷ 415V, 6 red, straight, IP66/IP67

### Product description

<b>Model</b>	plugs
<b>Version</b>	Heavy Duty
<b>Series</b>	PHW...SV
<b>Product type</b>	coupler
<b>Style</b>	straight
<b>Family</b>	plugs and socket-outlets
<b>N. of poles</b>	3 poles + N + 
<b>Clock position</b>	6

### Technical data

<b>Current</b>	63 A
<b>Voltage</b>	200/346 ÷ 240/415 V
<b>Frequency</b>	50 and 60 Hz.
<b>Operating temperature range (min, max)</b>	-40°C ... +125°C
<b>Material</b>	thermoplastic
<b>IP degree of protection</b>	IP66/IP67

### Further technical details

<b>Weight</b>	808,00 g
---------------	----------

### Approvals / Standards

<b>Reference standard</b>	EN 60309-1 and -2
---------------------------	-------------------

### General ordering information

<b>EAN13 code</b>	8015747144476
-------------------	---------------

### Packaging Information

<b>Packaging length</b>	190,00 mm
<b>Packaging height</b>	120,00 mm
<b>Packaging width</b>	290,00 mm
<b>Packaging weight</b>	1,62 kg
<b>Packaging volume</b>	6,61 dm <sup>3</sup>
<b>Packaging description</b>	Carton box
<b>Packaging quantity</b>	2 Pcs
<b>Packaging EAN code</b>	8015747144612

Part number

# PHW 6365 SV



## Catalogue drawings

(63 / 125A) PHW ... SV

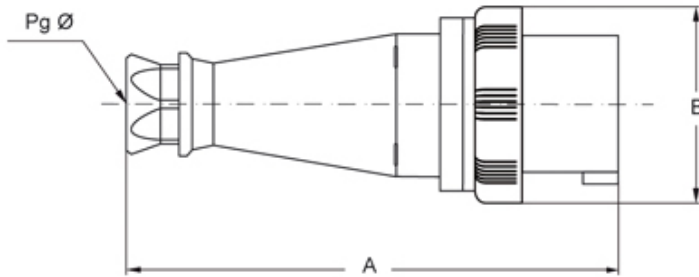

PHW...SV		A	B	Pg ø
63A	2P+⊕	264,5	112	36
	3P+⊕	264,5	112	36
	3P+N+⊕	264,5	112	36
125A	2P+⊕	310	130	2"gas
	3P+⊕	310	130	2"gas
	3P+N+⊕	310	130	2"gas

## Notes